

MightyMount™ Installation & Setup Guide

STRONGARM®
+healthcare

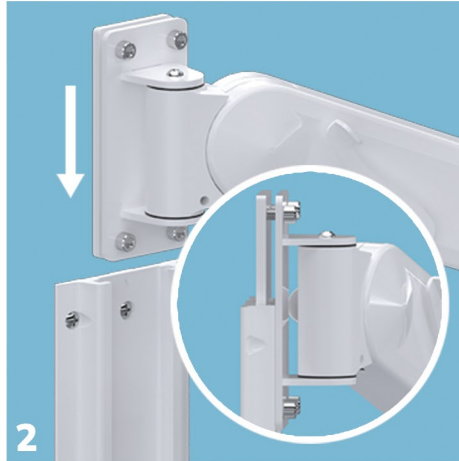

1
Install the mounting track in accordance with the instructions included with your track. Use a level to ensure track is plumb.



2
Insert the slider key into the mounting track to your preferred mounting height and hand tighten the four slider key bolts.



3
Ensure that the slider key is level and fully tighten the four slider key bolts using the supplied 1/4" hex key.

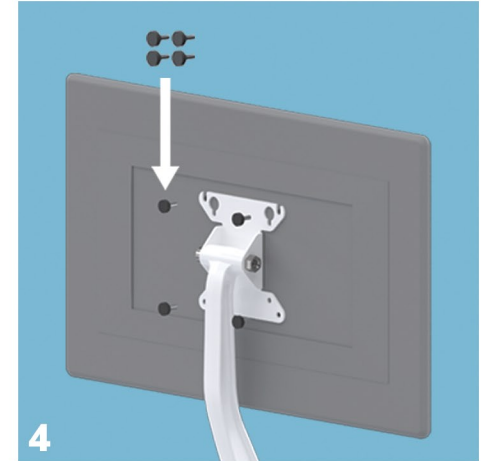

4
Attach your display to the display mount using the supplied M4x8 or M4x12 thumb screws.

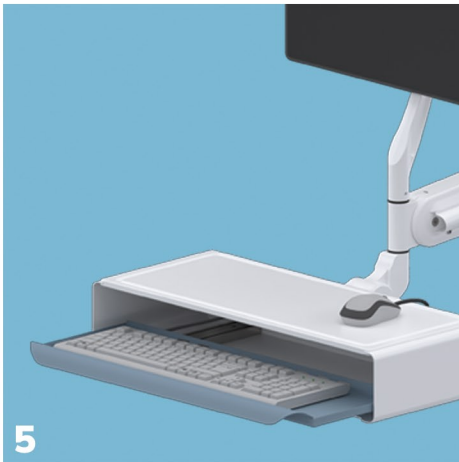

5
Slide open the keyboard tray. Place your keyboard into the tray. Your mouse cable can be routed through the back of the keyboard enclosure. Excess cable can be stowed and secured in the tray area adjacent to the USB hub in the next step.



6
To access the USB hub, rotate the cover latch on the rear of the keyboard enclosure and slide the work surface cover forward. Connect your keyboard and mouse cables to the USB hub. You may use the supplied USB extension cable routed through the back of the keyboard enclosure to connect the USB hub to your PC.

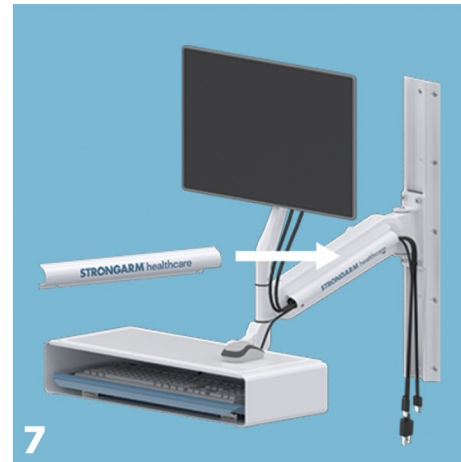

7
Align your display and USB cables along the MightyMount arm and attach the cable carrier using the two screws provided. The cables should be nested in the channel of the mounting track upwards or downwards, depending on your application.

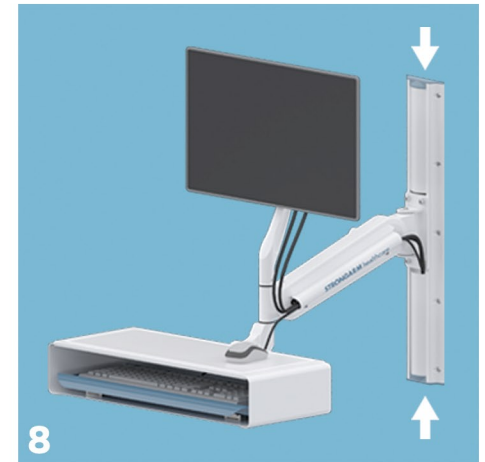

8
Trim the track cover (supplied with your mounting track) to the desired lengths and slide the track cover into the corresponding slots on the mounting track. Insert the top and bottom track caps.

MightyMount™ Ergonomics & Operating Guide

(See reverse side for the Installation Guide)



Vertical Positioning & Adjustment

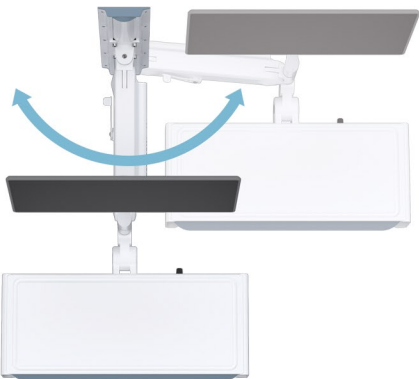

Left/Right Swivel

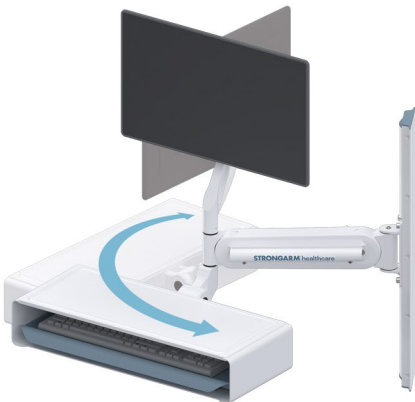

Keyboard Enclosure & Display Swivel



Display Tilt



Keyboard Enclosure Fold Up/Down

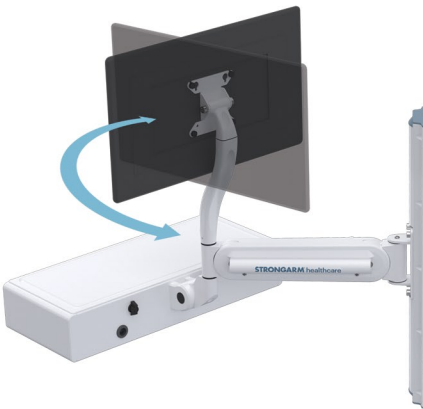

PatientView Display Swivel*
*On PatientView equipped models

Specifications

Adjustability	Vertical Travel	12" with MightyMount 16" with MightyMount XR
	Swivel at Display End	340°
	Swivel at Mounting End	180°
	Display Tilt	Forward tilt: 15° Backward tilt: 45°
Vertical Positioning		Counterbalanced vertical adjustability Display and keyboard maintain level when repositioned
Materials of Construction	Body	319F cast aluminum alloy
	Keyboard Tray	5052 aluminum alloy
Cable Management	Integrated internal/external cable covers	
Bearings	Horizontal Axles	Precision ground ball bearings
	Vertical Axles	Acetal bushings
Mounting Styles	Track mount, wall mount, or surface mount options available.	
Finish	2-part catalyzed polyurethane antimicrobial powder coat and custom colors available	
Approvals and Certifications	UL, CE, U.S. GSA Advantage, HCAi	